

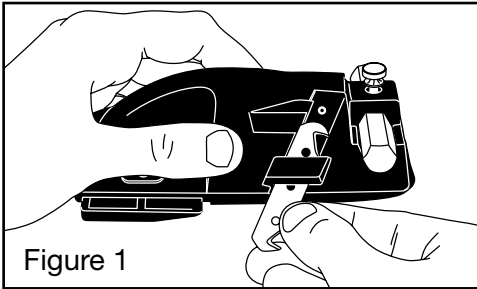

# Instructions for No. 320 Vinyl Wall Trimmer

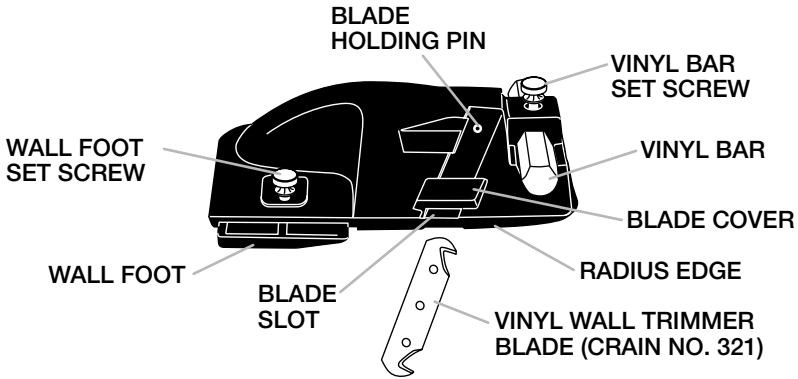

## BLADE INSTALLATION

**CAUTION: BLADE IS SHARP!**

Insert a vinyl wall trimmer blade (Crain No. 321) into the blade slot and push upwards through the blade cover (Figure 1).

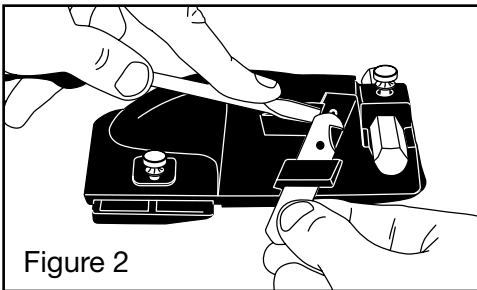

Continue pushing the blade until it reaches the blade holding pin. Lift the blade over the blade holding pin using a finger or a screwdriver for additional leverage (Figure 2).

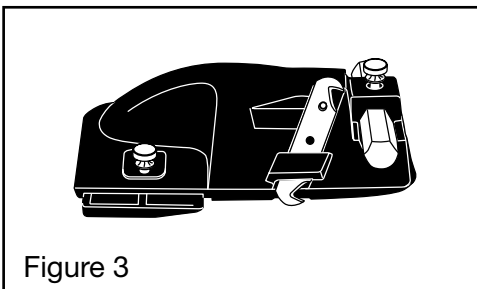

Push the blade over the blade holding pin until the blade holding pin inserts in the top hole of the blade (Figure 3).

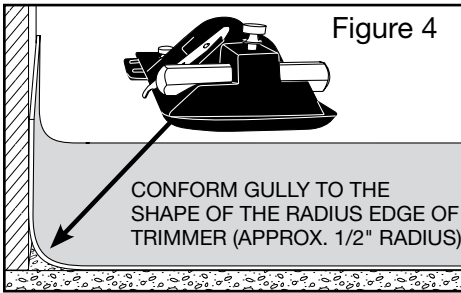

## USING THE VINYL WALL TRIMMER

STEP #1: Loose lay the vinyl at least 1" up the wall. Form the vinyl in the gully into an approximately 1/2" radius corresponding to the shape of the radius edge of the trimmer (Figure 4). Do not crease the vinyl sharply.

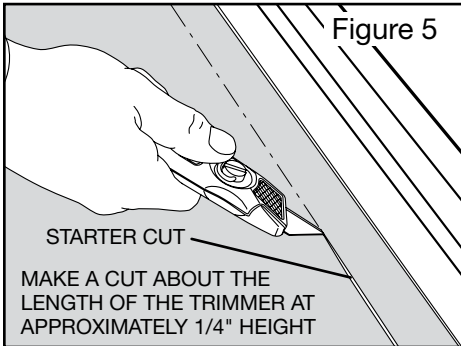

STEP #2: Make a starter cut with a knife about the length of the trimmer. The height of the starter cut on the radius at the gully should match the height of the trimmer blade (approximately 1/4" - Figure 5).

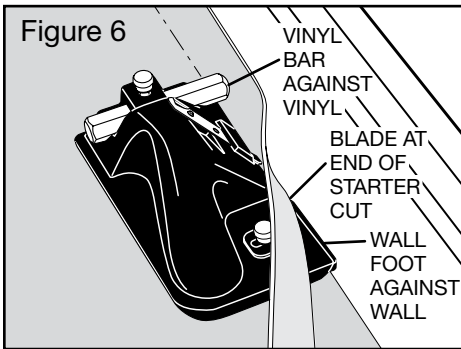

STEP #3: Put the blade of the trimmer into the starter cut and move it to the end of the cut. Press the radius edge of the trimmer into the 1/2" radius at the gully. Loosen the vinyl bar set screw and extend bar until it contacts the vinyl. Loosen the wall foot set screw and extend foot until it contacts the wall. Retighten set screws (Figure 6).

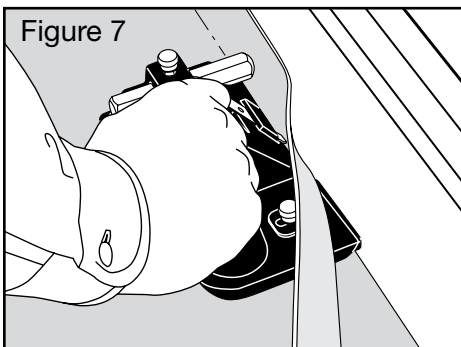

STEP #4: Push the trimmer along the wall keeping palm pressure towards the back. Keep the base flat on the floor, the radius edge of the trimmer against the gully, the vinyl bar against the vinyl, and the wall foot against the wall as you push the trimmer down the wall (Figure 7).