

# ◆ CRAIN No. 957 Detail Hand Groover

**WARNING:** Blades are sharp and can come out of the groove being cut with great force. Keep hands and face away!

## TERMINOLOGY:

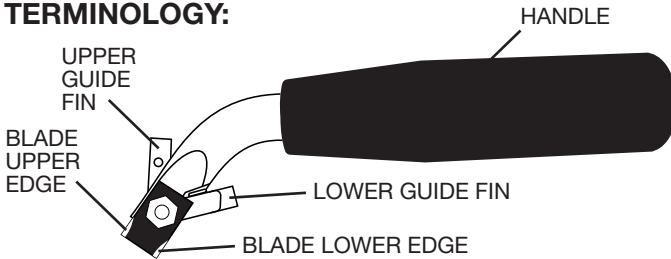

## BLADES:

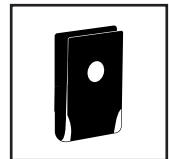

No. 958 - 3.5mm

**NOTE:** The tool comes with a 3.5mm U-Blade, and takes other standard U-Blades. Follow the flooring manufacturer's recommendations for the shape and depth of groove that is necessary.

## STARTING GROOVES & DEPTH CONTROL:

### STARTING BLADE:

To start a groove, angle the handle down, and pull to plunge the blade to desired depth, making sure the lower guide fin enters the seam.

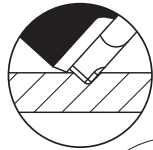
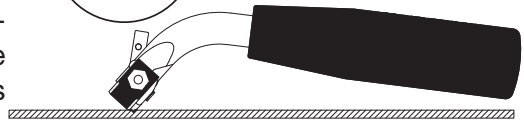

Figure 1



### CONTINUING GROOVE:

To continue the groove at the desired depth, gradually raise the handle so that it becomes parallel to the floor, and continue pulling on the handle.

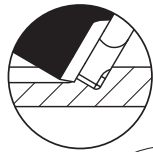
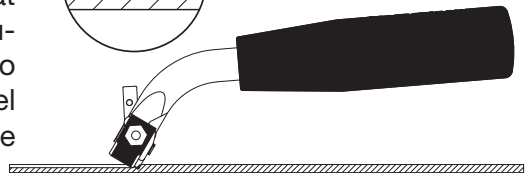

Figure 2



### REMOVING BLADE:

To remove the blade from the groove, raise the handle, and the blade will cut its way out of the material.

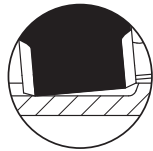
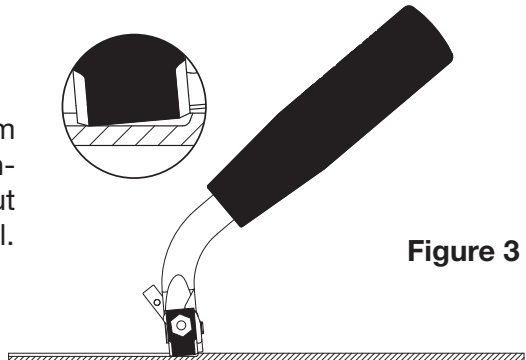
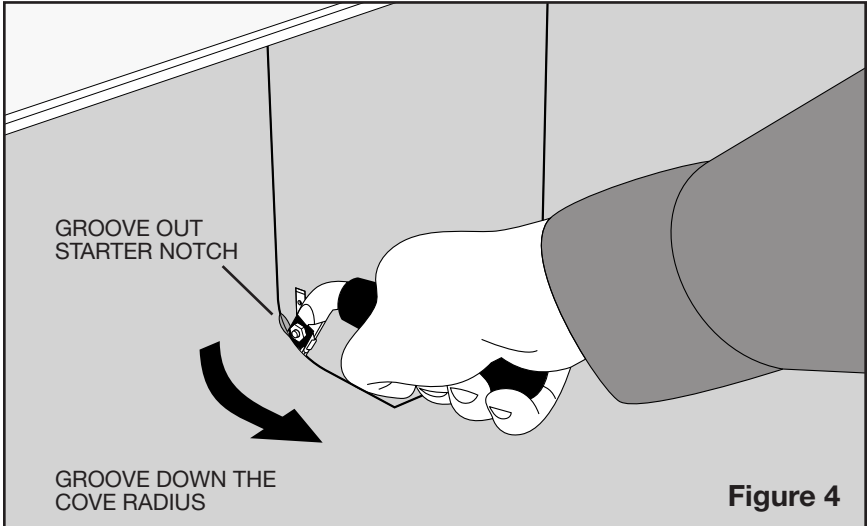

Figure 3



## GROOVING COVE SEAM AREAS

Groove out a starter notch by plunging the lower edge of the blade into the seam at a point about 2/3 of the way up the cove radius. Make sure the lower guide fin enters the seam.



Continue grooving the seam down the cove radius and onto the flat floor only as far as is necessary.

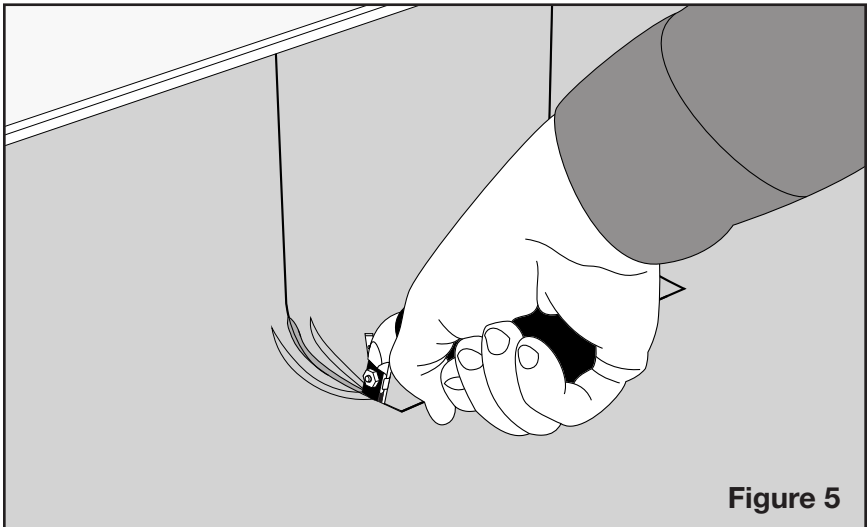

Return to the starter notch and push the upper edge of the blade into it. As you push the blade into the material, make sure the guide fin enters the seam. Groove the rest of the cove radius by continuing to push the tool up the cove radius.

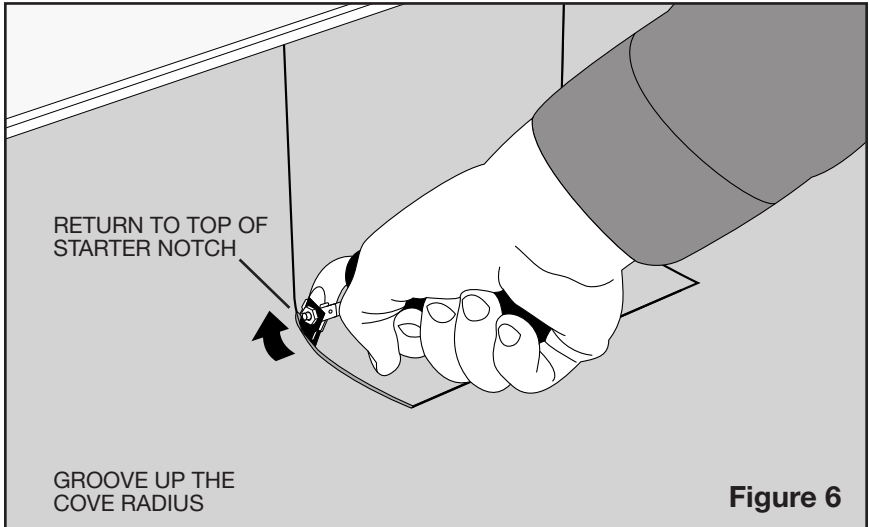

When the upper edge of the blade reaches the vertical wall, lift the handle straight up. Rotating the handle causes the blade to come out of the material.

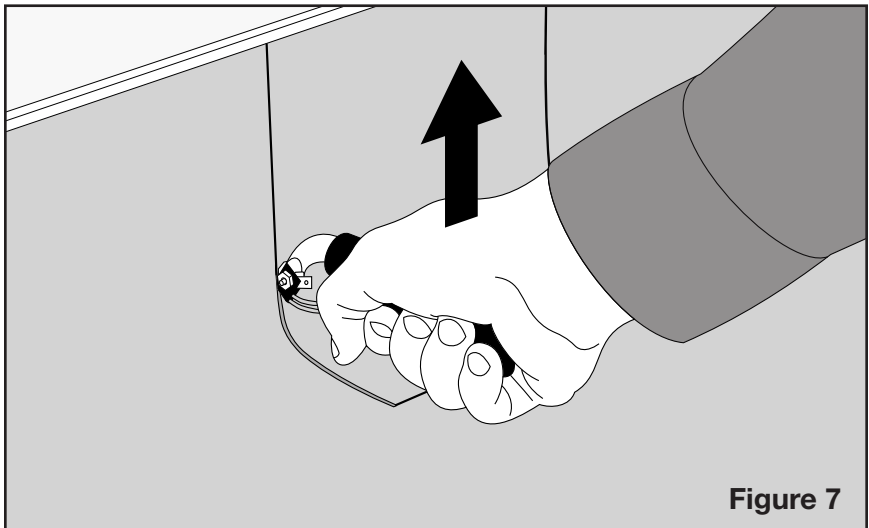

Continue grooving up the wall to the top of the seam by lifting the handle straight up.

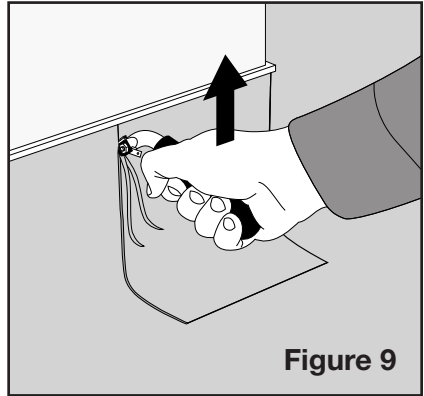
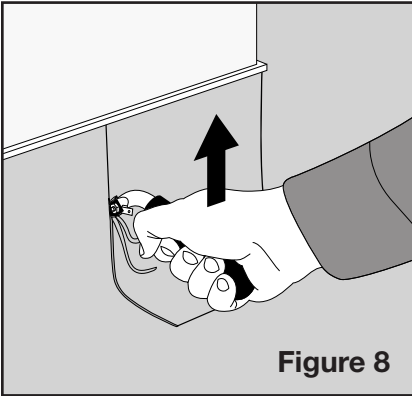

The hand groover can be used to make short detail grooves on the floor. Do not use where depth control is critical, such as on long seam areas, or seams out in the middle of the floor. Keep the guide fin in the seam to keep the blade centered in the seam.

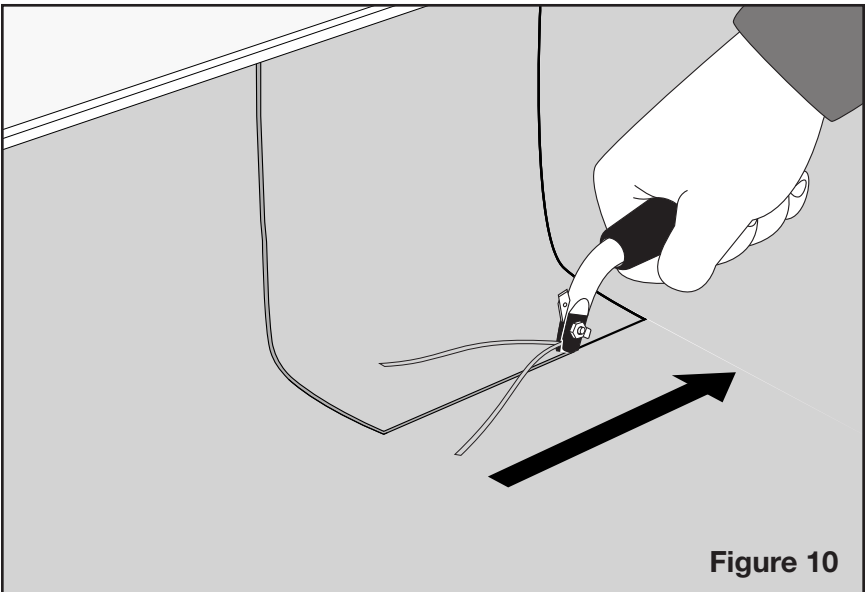

**NOTE:** Follow the flooring manufacturer’s recommendations with respect to the depth and shape of the groove that is necessary. A test groove and test weld on scrap material is highly advisable ON EVERY JOB before attempting to groove the actual floor.